

FOR LEASE ■ 135 Oser Avenue, Hauppauge, NY

1,738 Square Foot Office Space - Asking \$13.95/SF + Electric

- **No Loss Factor**
- **All Windowed Offices**
- **Six Private Offices**
- **Two Handicapped Lavatories In Suite**
- **Fully Equipped Eat-in Kitchen**
- **24/7 Access**
- **Pylon Signage on Lawn**
- **Immediate Occupancy**



"Full Commission
To Cooperating Brokers"



FOR MORE INFORMATION, PLEASE CONTACT

Mort Glick—Joel Gersten
Senior Managing Directors
631.770.0700

mort@metrorealtyservices.com; joel@metrorealtyservices.com

METRO REALTY SERVICES LLC

All information furnished regarding this property for sale or lease is from sources deemed reliable. No representation is made as to the accuracy thereof and submitted subject to errors, change of price, rental rates or other conditions, prior sales, lease, or withdrawal without notice. All areas and dimensions are approximate.

FOR LEASE ■ 135 Oser Avenue, Hauppauge, NY

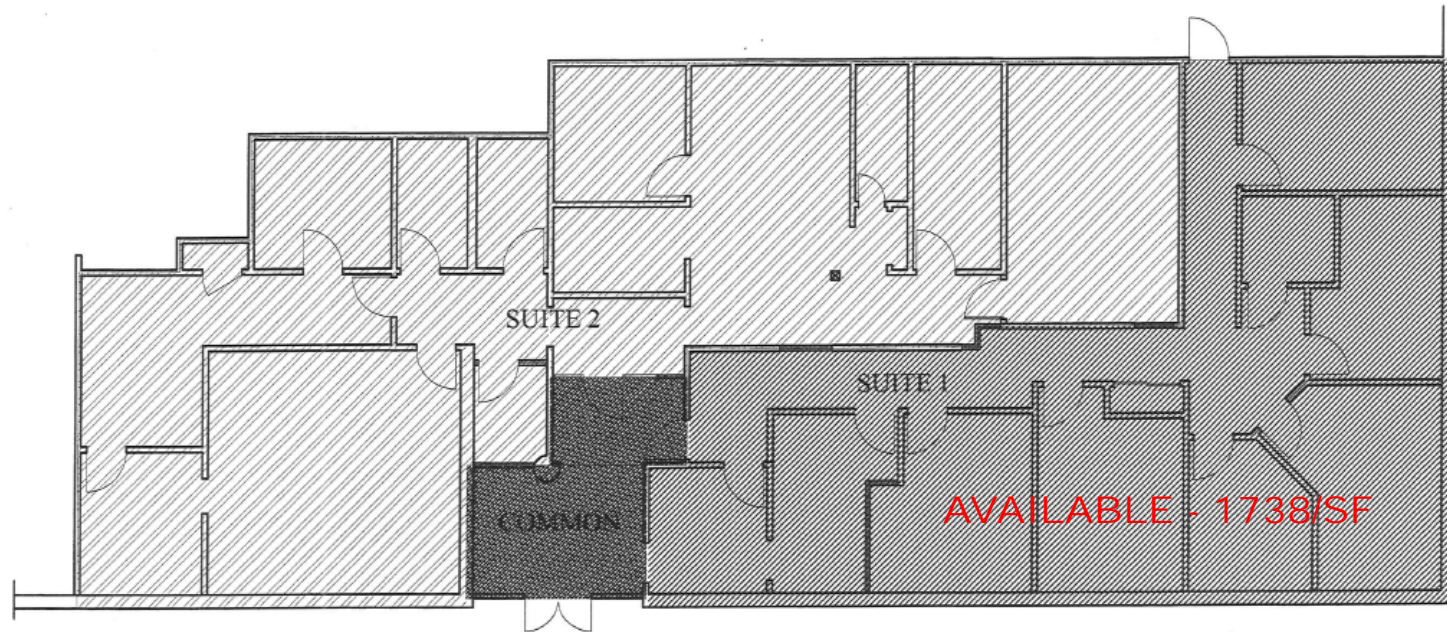

FLOOR PLAN

FOR MORE INFORMATION, PLEASE CONTACT

Mort Glick—Joel Gersten
Senior Managing Directors
631.770.0700

mort@metrorealtyservices.com; joel@metrorealtyservices.com

All information furnished regarding this property for sale or lease is from sources deemed reliable. No representation is made as to the accuracy thereof and submitted subject to errors, change of price, rental rates or other conditions, prior sales, lease, or withdrawal without notice. All areas and dimensions are approximate.

METRO REALTY SERVICES LLC